

Bosch Climate 5000 Series Single Zone Outdoor Unit

BMS500-AAS024-1CSXRC | BMS500-AAS024-1CSXHC | BMS500-AAS030-1CSXRC

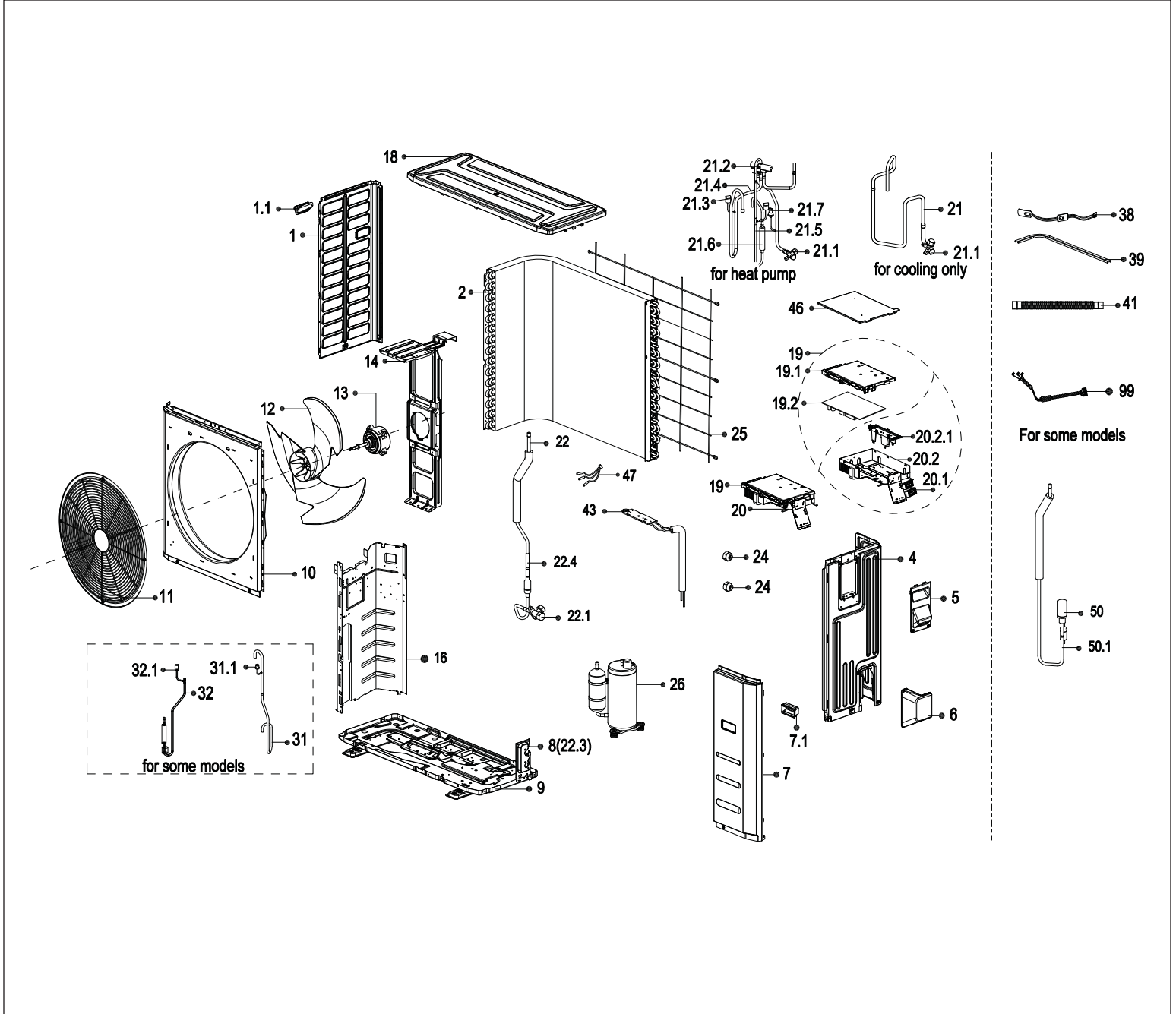

| Pos. | Description | Qty | BMS500-AAS024-1CSXRC | BMS500-AAS024-1CSXHC | BMS500-AAS030-1CSXRC | Recommended Stock | Remarks |
|--------|--|-----|----------------------|----------------------|----------------------|-------------------|---------|
| 1 | Left side plate assembly of cabinet | 1.0 | 7738005666 | 7738005666 | 7738005666 | | |
| 1.1 | Small handle | 1.0 | 7738005667 | 7738005667 | 7738005667 | | |
| 2 | Condenser assembly | 1.0 | 8733956383 | 8733956492 | 8733956383 | ✓ | |
| 4 | Rear right clapboard assembly | 1.0 | 7738005670 | 7738005670 | 7738005670 | | |
| 5 | Big handle assembly | 1.0 | 8733953825 | 8733953825 | 8733953825 | | |
| 6 | Water collector | 1.0 | 7738005672 | 7738005672 | 7738005672 | | |
| 7 | Front right clapboard assembly | 1.0 | 7738005673 | 7738005673 | 7738005673 | | |
| 7.1 | handle | 1.0 | 7738005674 | 7738005674 | 7738005674 | | |
| 9 | Chassis assembly | 1.0 | 7738005675 | 7738005675 | 7738005675 | | |
| 10 | Front panel | 1.0 | 7738005676 | 7738005676 | 7738005676 | | |
| 11 | Air outlet grille | 1.0 | 8733956372 | 8733956372 | 8733956372 | | |
| 12 | Axial flow fan | 1.0 | 7738005678 | 7738005678 | 7738005678 | ✓ | |
| 13 | Brushless DC Motor | 1.0 | 7738005679 | 7738005679 | 7738005679 | ✓ | |
| 14 | Supporter subassembly of fan motor | 1.0 | 7738005680 | 7738005680 | 7738005680 | | |
| 16 | Partition board assembly | 1.0 | 8733956458 | 8733956384 | 8733956384 | | |
| 18 | Top cover assembly | 1.0 | 7738005682 | 7738005682 | 7738005682 | | |
| 19 | Electronic control box subassembly | 1.0 | 8733956459 | 8733956493 | 8733956385 | ✓ | |
| 19.1 | Cover of electronic control box | 1.0 | 8733956455 | 8733956386 | 8733956386 | | |
| 19.2 | Outdoor main control board subassembly | 1.0 | 8733956460 | 8733956494 | 8733956387 | ✓ | |
| 20 | Terminal board subassembly | 1.0 | 8733956389 | 8733956388 | 8733956388 | ✓ | |
| 20.1 | Terminal | 1.0 | 8733956461 | 8733956389 | 8733956389 | ✓ | |
| 20.2 | Electronic installing box subassembly | 1.0 | 8733956462 | 8733956390 | 8733956390 | | |
| 20.2.1 | U-Typed Support with Copper Pipe | 1.0 | 7738005691 | 8733956391 | 8733956391 | | |
| 21 | 4-way valve assembly | 1.0 | 7738005692 | 8733956462 | 8733953829 | ✓ | |
| 21.1 | Gas valve | 1.0 | 8733956463 | 7738005691 | 7738005691 | | |
| 21.2 | 4-way valve | 1.0 | 8733956464 | 7738005692 | 7738005692 | | |
| 21.4 | Suction pipe | 1.0 | 8733945613 | 8733956463 | 8733953830 | | |
| 21.5 | Discharge pipe | 1.0 | 8733956465 | 8733956464 | 8733953831 | | |
| 21.6 | Muffler | 1.0 | 8733953940 | 8733945613 | 8733945613 | ✓ | |
| 22 | Liquid valve assembly | 1.0 | 7738005694 | 8733956495 | 8733956392 | ✓ | |
| 22.1 | Liquid valve | 1.0 | 7738005695 | 8733953940 | 8733953940 | | |
| 22.3 | Valve plate | 1.0 | 8733956466 | 7738005695 | 7738005695 | | |
| 22.4 | Throttle valve | 1.0 | 8733956451 | 8733956393 | 8733956393 | ✓ | |
| 24 | Copper nut | 1.0 | 8733956452 | 8733953585 | 8733953586 | | |
| 24 | Copper nut | 1.0 | 8733953586 | 8733953586 | 8733953585 | | |
| 25 | Rear net | 1.0 | 8733953585 | 7738005696 | 7738005696 | | |
| 26 | DC Inverter rotary compressor | 1.0 | 7738005696 | 8733956379 | 8733956394 | ✓ | |
| 38 | Crankcase electric heater | 1.0 | 8733956379 | 8733956456 | 8733956381 | | |
| 39 | Electric heating tube | 1.0 | 8733956467 | 8733956380 | 8733956380 | | |
| 41 | Drain pipe | 1.0 | 8733956381 | 8733947976 | 8733947976 | ✓ | |
| 43 | Radiator subassembly | 1.0 | 8733956380 | 8733956395 | 8733956395 | | |
| 46 | Cover of electronic control box | 1.0 | 8733947976 | 8733956396 | 8733956396 | | |
| 47 | Combination sensor | 1.0 | 8733956397 | 8733956397 | 8733956397 | ✓ | |
| 50 | Throttle valve subassembly | 1.0 | 8733956399 | 8733956496 | 8733956398 | ✓ | |
| 50.1 | Electronic expansion valve body | 1.0 | N/A | 8733956881 | 7738005694 | ✓ | |
| 99 | Compressor wire subassembly | 1.0 | N/A | 8733956399 | 8733956399 | | |

BMS500-AAS024-1CSXRC | BMS500-AAS024-1CSXHC | BMS500-AAS030-1CSXRC