

INSTALLATION INSTRUCTIONS

Soap/Lotion Dispensers Part #'s: 1205, 1206

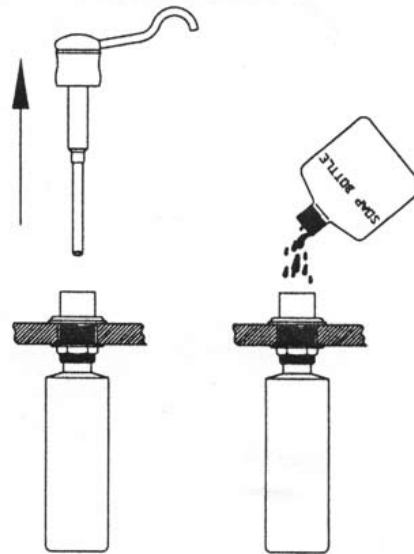
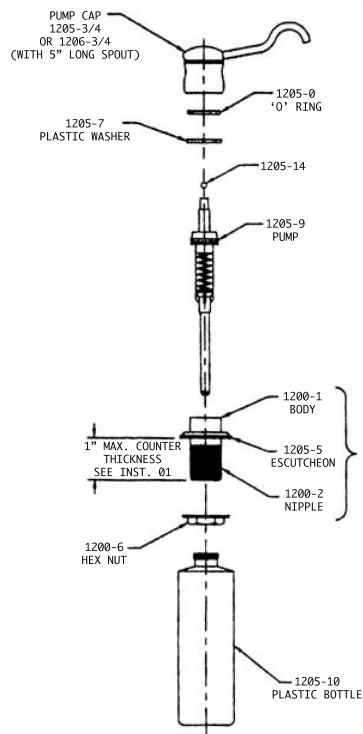

INSTALLATION

1. Drill 1-3/16" wide hole (minimum) in sink or counter. Place threaded part of pump body through the hole. Note: Maximum counter thickness is 1". Use extension kit SD-EXT to fit counters up to 2-1/2".
2. From underneath counter, thread 1200-6 nut onto pump body
3. Screw plastic bottle into female thread of pump body.
4. To add liquid soap or lotion, lift pump cap 1205-3/4 or 1206-3/4 (pump remains attached) and pour into dispenser body. Replace pump cap and pump several times. Liquid should flow from spout.

REFILLING SOAP/LOTION

1. Lift off cap, but do not separate pump from cap.
2. Refill by pouring liquid into top of pump body. Do not over-fill (liquid should remain in plastic bottle).

PUMP MAINTENANCE

Liquid soaps vary in consistency and may harden over time. Follow the procedures below if the pump fails to operate.

1. Remove cap and pump assembly and place tube into a glass of warm water. Pump several times until water pumps freely.
2. If the mechanism still fails to operate properly, insert a pipe cleaner into the tube to clear any obstructing soap from the plastic and metal tubing. Follow up by soaking in warm water.

To learn more about JACLO's warranty, please visit [**jaclo.com**](http://jaclo.com)